



Weather Shield® 6204/8204 Parts Reference Catalog

#1204632

Premium Windows & Doors

FOR PRODUCT PRODUCED AFTER 02/06



Casement

CASEMENT

Awning



AWNING

French Casement

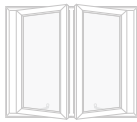

FRENCH
CASEMENT

Scena-Vu

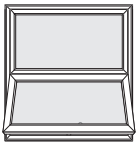

SCENA-VU

Bow/Bay



BOW/BAY

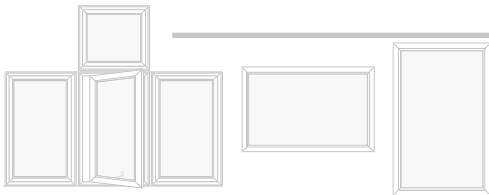

- Mull/Stack
- Transom
- Picture

MULL/STACK
TRANSOM
PICTURE

Order Form



ORDER
FORM

Measuring

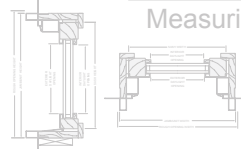

MEASURING

Weather Shield Mfg., Inc.
Medford, WI 54451 • 715-748-2100



TABLE OF CONTENTS:

Wood Awning Exploded View	1
Aluminum Clad Awning Exploded View	2
Wood Svena-Vu Exploded View	3
Aluminum Clad Scena-Vu Exploded View	4
Awning/Scena-Vu Replacement Parts	5
Standard Screen Exploded View	9
Standard Screen Replacement Parts	10

AWNING

DESCRIPTION:

Wood window with aluminum or wood exterior

INTERIOR OPTIONS:

Species: Pine, Knotty Pine, American Fir, Oak, Cherry, Maple, Mahogany, Alder

Finish: Natural, Primed, Poly (Standard, Designer, or Custom Color)

EXTERIOR OPTIONS:

Wood: Natural, Primed, Poly (Standard, Designer, or Custom Color)

Clad: White, Cameo, Desert Tan, Western Adobe, Craftsman Bronze, Obsidian, Hartford Green, Designer Color, Custom Color, Anodized finish

HARDWARE OPTIONS:

Bright Brass, Goldtone, White, Adobe, Oil Rubbed Bronze, Brushed Nickel, Brushed Chrome

DISTINGUISHING FEATURES:

- Aluminum and/or wood construction
- 4-9/16" jamb depth
- Wood interior

HOW TO ORDER A PART:

Identify the part using the **exploded view** and index. Locate the part in the **replacement parts** section using the **reference number** from the exploded view and index for a detailed part view and ordering information. Use the **configured number**, **extrusion number**, and/or **part number** shown next to your part to place your order. **When identifying replacement parts, unit must be viewed from the exterior.** Replacement parts for non-rectangular special shapes can be ordered using the Order Form section #1203399.

- Exploded View:** Drawings show part location and are accompanied by indexes that reference part descriptions.
- Replacement Parts:** Sections contain detailed views of individual replacement parts and ordering information.
- Reference Number:** Shown in black boxes on the exploded views and listed numerically in the indexes. Parts appear sequentially by reference number in the replacement parts sections.
- Configured Number:** Use to enter your order in CustomQuote™.*
- Extrusion Number:** Reference when placing an order with your Customer Relations Representative.
- Part Number:** Reference when placing an order with your Customer Relations Representative.

* **NOTE:** Some configured numbers MAY NOT be active at the time of your order. CustomQuote™ software is updated regularly to accommodate new configured numbers. If a configured number is not active, please comment the part for ordering. Contact your Customer Relations Representative for assistance.

GLASS IDENTIFICATION CODE:

The glass code number references the date of manufacture, which is helpful in identifying the product.

When ordering warranty replacement glass, sash or panels, it is necessary to specify the glass identification code.

Markings are stamped on one of the four sides of the spacer which separates the two panes of glass. (see illustration at right)

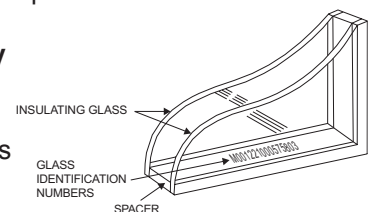

SCENA-VU

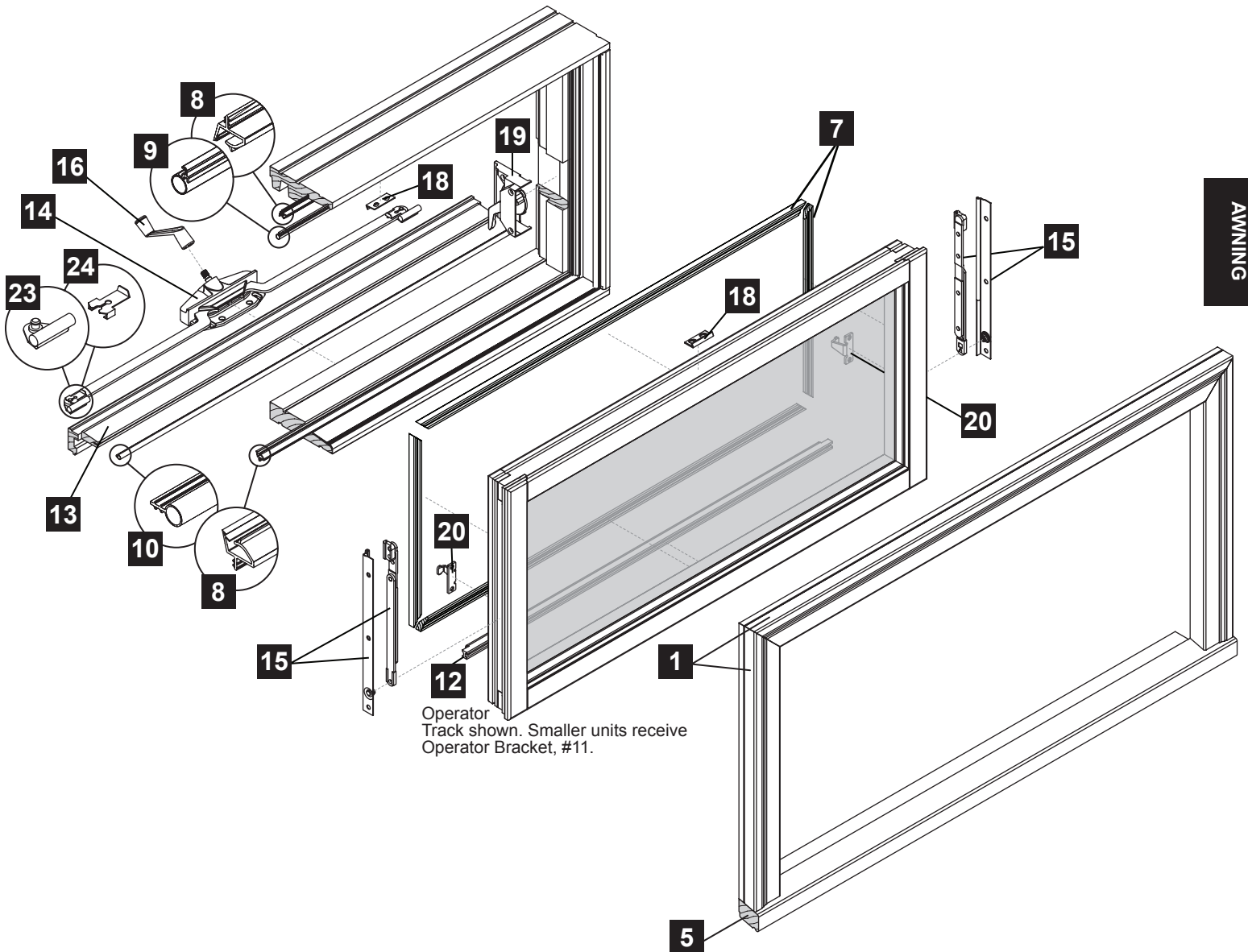

Parts Shown **Page**

1	Exterior Trim	3
5	Subsill	3
7	Glazing Bead	4
8	Dual Seal Weatherstrip	4
9	Bulb Weatherstrip ¹	4
10	Bulb Weatherstrip ²	4
12	Guide Bar	5
13	Operator Cover	5

14	Operator	5
15	Hinge	5
16	Operator Handle (a,b,c,d,e)	6
18	Snubber	7
19	Sash Lock	7
20	Keeper (a,b)	7
23	Shoe Stud	8
24	Operator Quick Release Clip	8

Parts Not Shown **Page**

11	Operator Bracket	4
17	Handle Extension	6
22	Jamb Extension	7

¹ For Head/Side
² For Operator Cover



AWNING

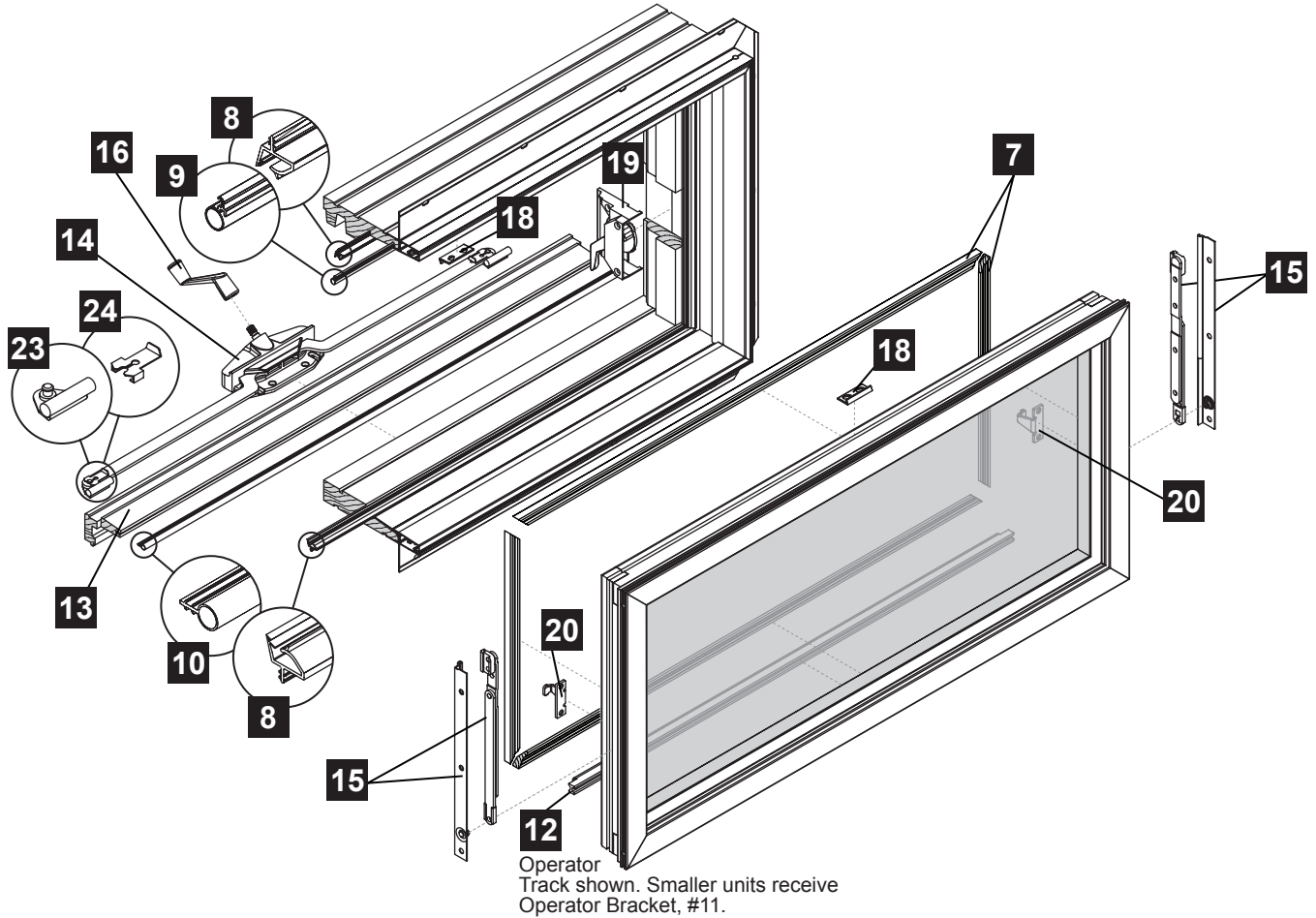

Operator
Track shown. Smaller units receive
Operator Bracket, #11.

Parts Shown **Page**

7	Glazing Bead	4
8	Dual Seal Weatherstrip.....	4
9	Bulb Weatherstrip ¹	4
10	Bulb Weatherstrip ²	4
12	Guide Bar	5
13	Operator Cover	5
14	Operator	5
15	Hinge	5

¹ For Head/Side
² For Operator Cover

16	Operator Handle (a,b,c,d,e).....	6
18	Snubber	7
19	Sash Lock.....	7
20	Keeper (a,b).....	7
23	Shoe Stud.....	8
24	Operator Quick Release Clip.....	8

Parts Not Shown **Page**

2	Exterior Trim	3
3	1" Alum. B'mould Corner Key	3
4	Alum. B'mould Corner Key	3
6	Subsill	3
11	Operator Bracket	4
17	Handle Extension	6
21	Drip Cap	7
22	Jamb Extension	7

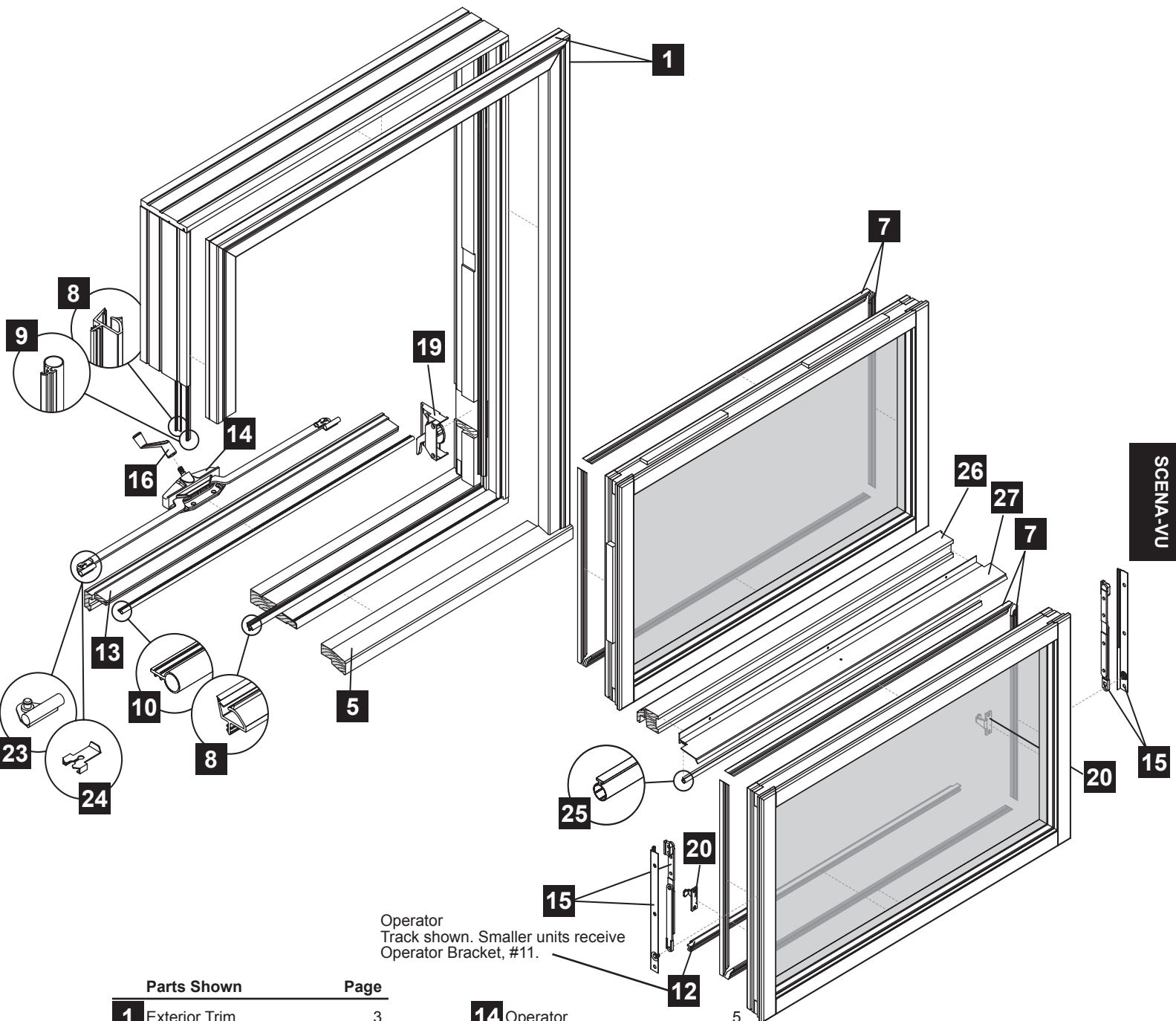

Operator Track shown. Smaller units receive Operator Bracket, #11.

SCENA-VU

Parts Shown	Page
1 Exterior Trim	3
5 Subsill	3
7 Glazing Bead	4
8 Dual Seal Weatherstrip.....	4
9 Bulb Weatherstrip ¹	4
10 Bulb Weatherstrip ²	4
12 Guide Bar	5
13 Operator Cover.....	5

14 Operator	5
15 Hinge	5
16 Operator Handle (a,b,c,d,e).....	6
19 Sash Lock.....	7
20 Keeper (a,b).....	7
23 Shoe Stud.....	8
24 Operator Quick Release Clip.....	8

Parts Not Shown	Page
11 Operator Bracket	4
17 Handle Extension	6
22 Jamb Extension.....	7

¹ For Head/Side
² For Operator Cover

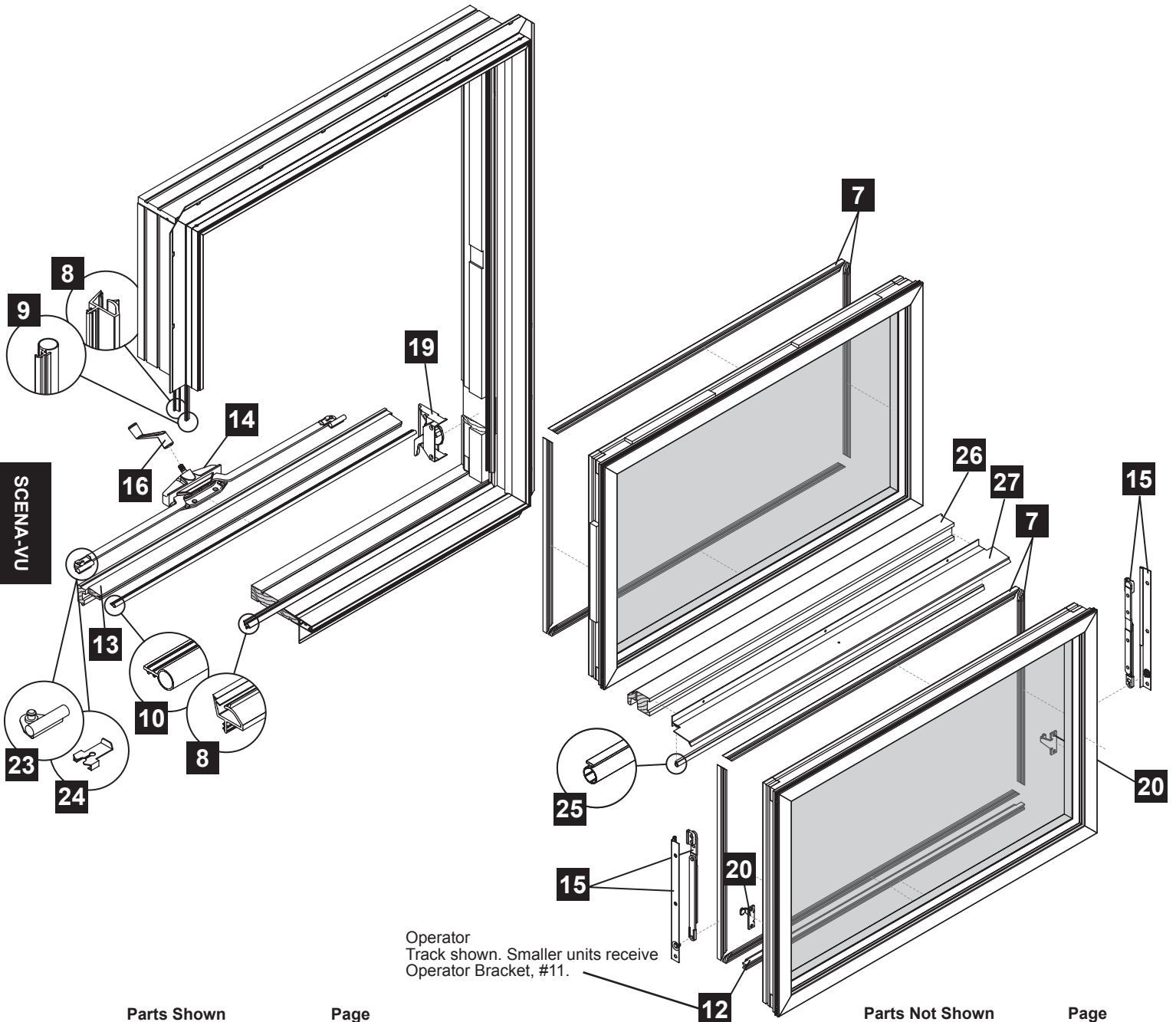

Parts Shown **Page**

7	Glazing Bead.....	4
8	Dual Seal Weatherstrip.....	4
9	Bulb Weatherstrip ¹	4
10	Bulb Weatherstrip ²	4
12	Guide Bar.....	5
13	Operator Cover.....	5
14	Operator.....	5
15	Hinge.....	5

16	Operator Handle (a,b,c,d,e).....	6
19	Sash Lock.....	7
20	Keeper (a,b).....	7
23	Shoe Stud.....	8
24	Operator Quick Release Clip.....	8

Parts Not Shown **Page**

2	Exterior Trim.....	3
3	1" Alum. B'mould Corner Key	3
4	Alum. B'mould Corner Key.....	3
6	Subsill.....	3
11	Operator Bracket.....	4
17	Handle Extension.....	6
21	Drip Cap.....	7
22	Jamb Extension.....	7

¹ For Head/Side
² For Operator Cover



1 Wood Exterior Trim

Specify Finish (See pg. i, Exterior Options, for information)

Brick Mould

Washington Style

Stucco Mould

Flat Casing

Franklin Casing

NOTE: For replacement on radius units, refer to Order Form section.

- A) Configured Number: C1159706
- B) Configured Number: C1159703
- C) Configured Number: C1159696
- D) Configured Number: C1159718
- E) Configured Number: C741768

2 Aluminum Exterior Trim

Specify Color (See pg. i, Exterior Options, for information) *Items 3,4, and/or 6 may need to be ordered with your trim.*

1" Brick Mould

Washington Style *

2" Brick Mould *

Flat Casing *

Historical Casing *

NOTE: For replacement on radius units, refer to Order Form section. ** For pre-installation replacement only.*

- A) Configured Number: C963443 Extrusion Number: 04-2183
- B) Configured Number: C968635 Extrusion Number: 1528
- C) Configured Number: C968621 Extrusion Number: 1549
- D) Configured Number: C968628 Extrusion Number: 1545
- E) Configured Number: C963664 Extrusion Number: 04-2181

3 1" Aluminum Brickmould Corner Key Pack

Pack contains:
 (2) Insect Barrier
 (2) Corner Key
 (2) #7 x 3/4" 410 SS panhead screws
 (4) #8 x 3/8" flat head screws
 (1) Instruction sheet
 (1) Installation Clip Instruction

Part Number: 1162737

4 Aluminum Brickmould Corner Key Pack

Pack contains:
 (2) Insect Barrier
 (4) Corner Key
 (6) #6 x 1-1/4" 410 SS flat head screws
 (1) Installation Instructions
 (1) Instruction sheet

Part Number: 1162738

5 Wood Subsill

Specify Finish (See pg. i, Exterior Options, for information) *For pre-installation replacement only.*

Standard: New England:

Configured Number: (Standard) C310010
 (New England) C311722

6 Aluminum Subsill

Configured Number: C968571
 Extrusion Number: 1552

AWNING

SCENA-VU



AWNING

7 Glazing Bead

Specify Species/Finish

(See pg. i, Interior Options, for information)

Putty:

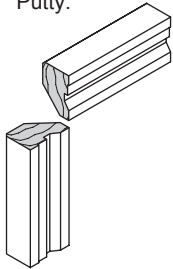

Insul/Triple Insul



1/8"-1/4" Single Glaze



7/16"-9/16" Single Glaze

Colonial:

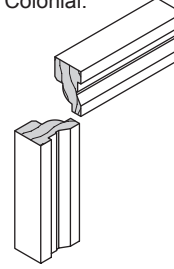

Insul/Triple Insul

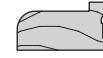

1/8"-1/4" Single Glaze



7/16"-9/16" Single Glaze

Configured Number: (Putty) C311502
(Colonial) C110239

SCENA-VU

8 Dual Seal Weatherstrip

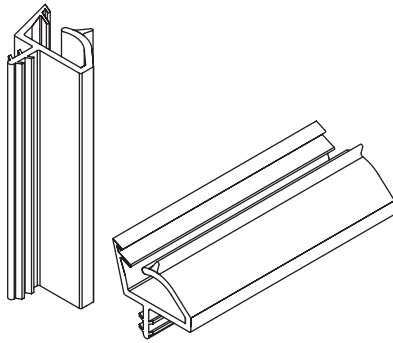

Configured Number: C750769
Part Number: (Horizontal) 051768
(Vertical) 051769 } (AS400 use only)
Extrusion Number: 60-4714

9 Bulb Weatherstrip (Head & Side Jamb)

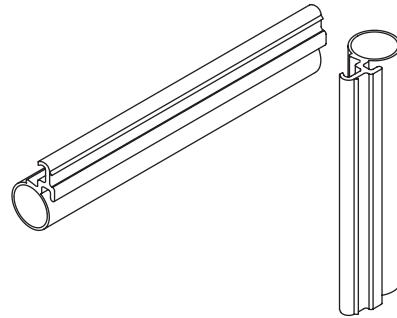

Configured Number: C740392
Part Number: 730128 (AS400 use only)
Extrusion Number: 2010

10 Bulb Weatherstrip (Operator Cover)

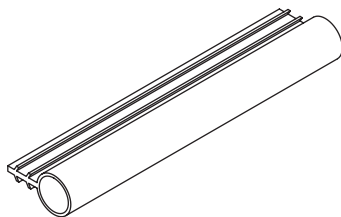

Configured Number: C761553
Part Number: 741187 (AS400 use only)
Extrusion Number: 5090

11 Operator Bracket

- E-Guard
- Seacoast

*For Awning units
with small operator
(see item #14).*

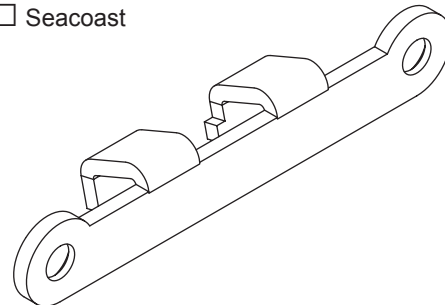

Part Number: (E-Guard) 972007
(Seacoast) 972771



12 Operator Guide Bar

For Awning units with Large Operator (see item #14). Available with mill finish aluminum only.

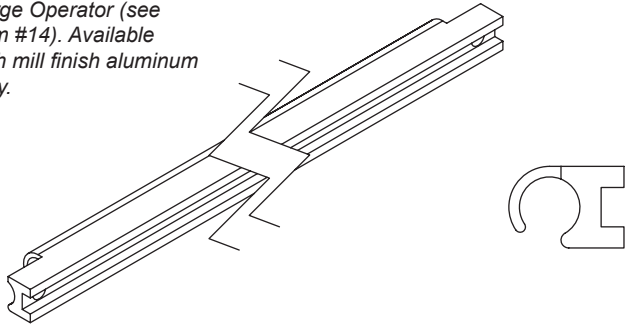

Configured Number: C969196
Extrusion Number: 3505

13 Operator Cover (weatherstrip included)

Specify Species/Finish _____
(See pg. 1, Interior Options, for information)

Specify Overall Length _____

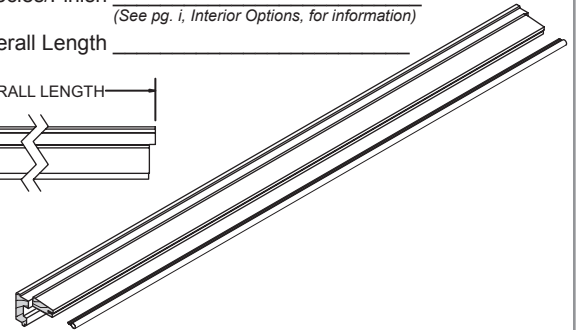
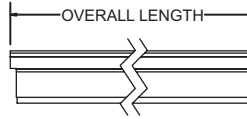

Configured Number: C312024

AWNING

14 Operator

Finish	Part Number			
	Small Operator		Large Operator	
	Standard	Seacoast	Standard	Seacoast
White	972995	972996	972994	972997
Goldtone	972006	972794	972005	972760
Adobe	972118	940870	972973	940871
Bright Brass	972195	N/A	972514	N/A
Oil Rubbed Bronze	941417	N/A	941420	N/A
Brushed Nickel	941418	N/A	941421	N/A
Brushed Chrome	941419	N/A	941422	N/A

Small (for glass sizes less than 28"): Large (for 28" glass size and larger):

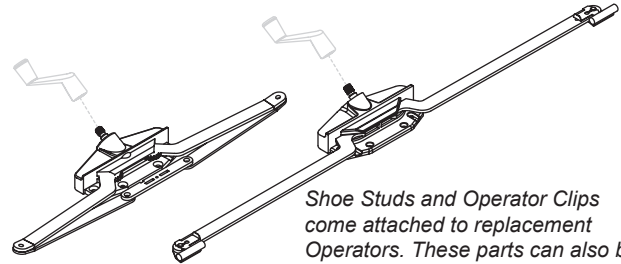

Shoe Studs and Operator Clips come attached to replacement Operators. These parts can also be ordered individually. See Items #23 and #24 for ordering information.

SCENA-VU

15 Hinge

Finish	Part Number			
	Left		Right	
	10"	18"	10"	18"
Standard	972922	972065	972923	972066
Stainless Steel	972660	411612	972661	411613

- 10" Adjustable
- 18"

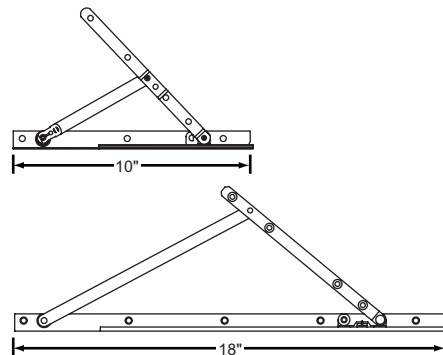



AWNING

16a Folding Handle

Finish	Part Number
White	942167
Goldtone	942168
Adobe	942169
Bright Brass	942170
Oil Rubbed Bronze	942171
Brushed Nickel	942172
Brushed Chrome	942173

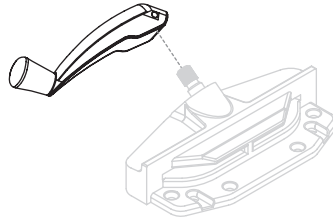

16b Contour Handle

Finish	Part Number
White	941911
Goldtone	941907
Adobe	941915
Bright Brass	941917
Oil Rubbed Bronze	941922
Brushed Nickel	941918
Brushed Chrome	941923

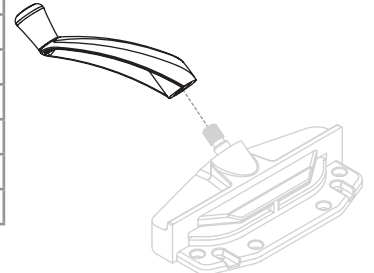

SCENA-VU

16c T Handle

Finish	Part Number
White	972991
Goldtone	972268
Adobe	972648
Bright Brass	972393
Oil Rubbed Bronze	941435
Brushed Nickel	941436
Brushed Chrome	941437

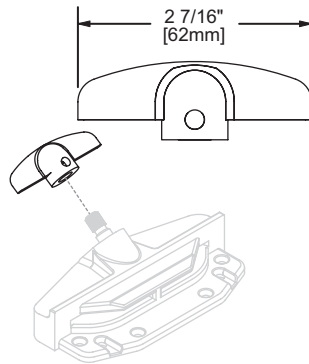

16d Round Handle

Finish	Part Number
White	940044
Goldtone	972069
Adobe	972130
Bright Brass	972338
Oil Rubbed Bronze	941438
Brushed Nickel	941439
Brushed Chrome	941440

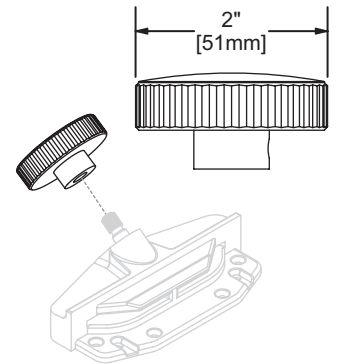

16e ADA Handle

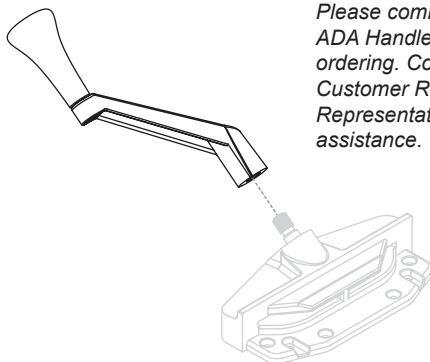

Please comment ADA Handle when ordering. Contact your Customer Relations Representative for assistance.

17 Handle Extension

- 2"
- 4"

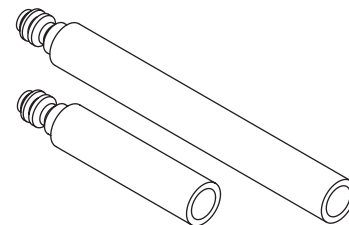

Available in Goldtone only.

Part Number: (2") 972067
 (4") 972068



18 Snubber

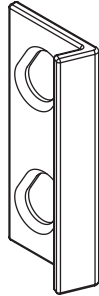

Snubbers are used in pairs as a performance upgrade on Awning units. Quantity varies depending on unit size.

Part Number: 972524 (one snubber)

19 Sash Lock

Finish	Part Number	
	Left	Right
Oil Rubbed Bronze	941423	941426
Brushed Nickel	941424	941427
Brushed Chrome	941425	941428
Goldtone	972003	972000
Adobe	972125	972126
Bright Brass	972164	972165

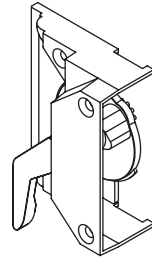

Lefthand Shown
Righthand Opposite

20a E-Guard Keeper

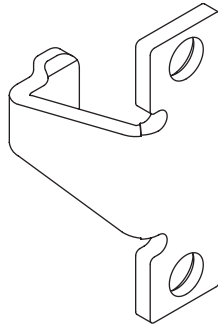

Part Number: 972009

20b Reinforced Keeper (SPU)

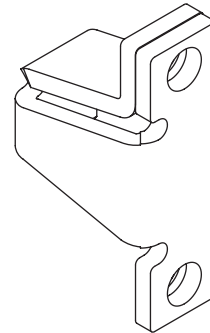

Available in
Stainless Steel
only.

Lefthand Shown
Righthand Opposite

Part Number: (Left) 982502
(Right) 982503

21 Aluminum Drip Cap

Specify Color _____
(See pg. i, Exterior Options, for information)

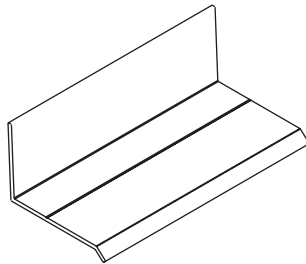

Configured Number: C963395
Extrusion Number: 04-2064

22 Jamb Extension

Specify Species/Finish _____
(See pg. i, Interior Options, for information)

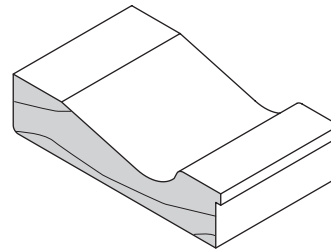

Configured Number: (each) C1027663
(set) C010000-JES

AWNING

SCENA-VU



AWNING

23 Shoe Stud

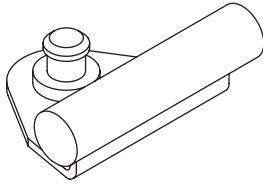

Also comes attached to replacement Operator. See Item #14 for ordering information.

Part Number: 972011

24 Operator Quick Release Clip

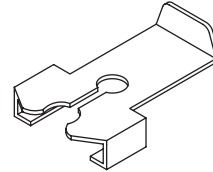

Also comes attached to replacement Operator. See Item #14 for ordering information.

Part Number: 972064

SCENA-VU

25 Horizontal Mullion Weatherstrip

- White
- Beige

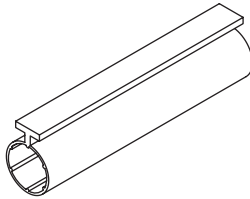

Available on Scena-Vu only.

Configured Number: C740391
 Part Number: (White) 760025
 (Beige) 760012] (AS400 use only)
 Extrusion Number: 2107

26 Wood Horizontal Mullion

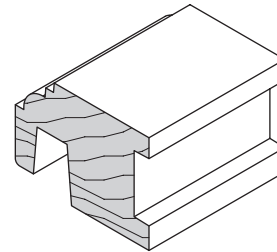

Available on Scena-Vu only.

Configured Number: C411538

27 Aluminum Horizontal Mullion (weatherstrip included)

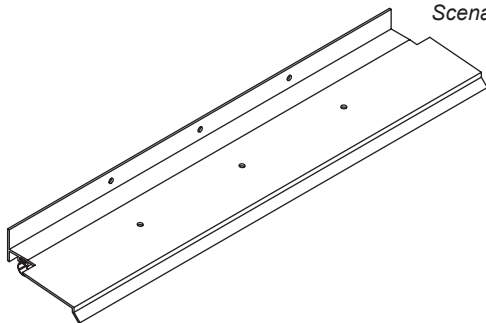

Available on Scena-Vu only.

Configured Number: C969038
 Extrusion Number: 3508

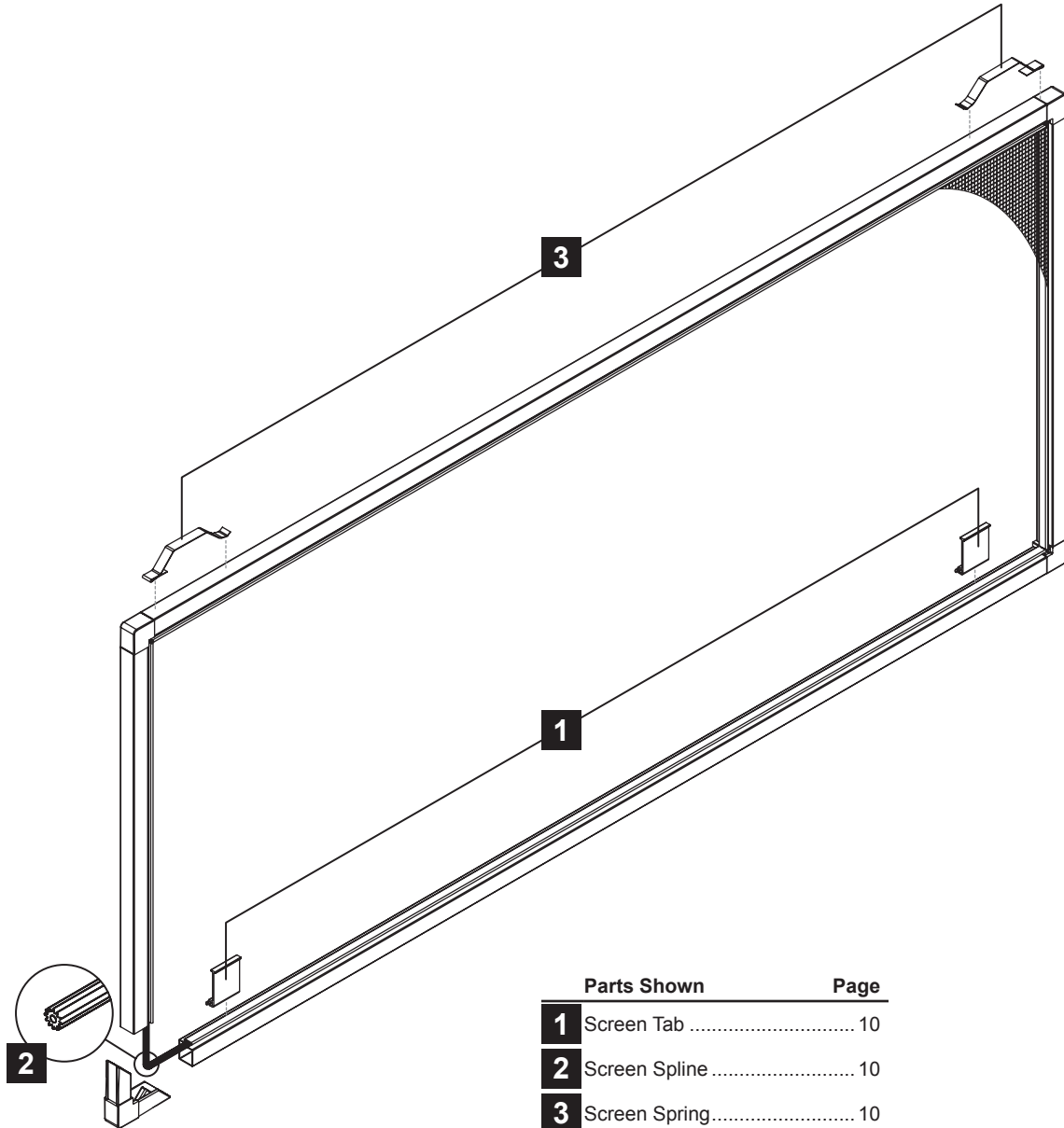

AWNING

SCENA-VU

Parts Shown	Page
1 Screen Tab	10
2 Screen Spline	10
3 Screen Spring	10

To order entire screen frame or mesh, see the Order Form section, #1203399.



AWNING

1 Screen Tab

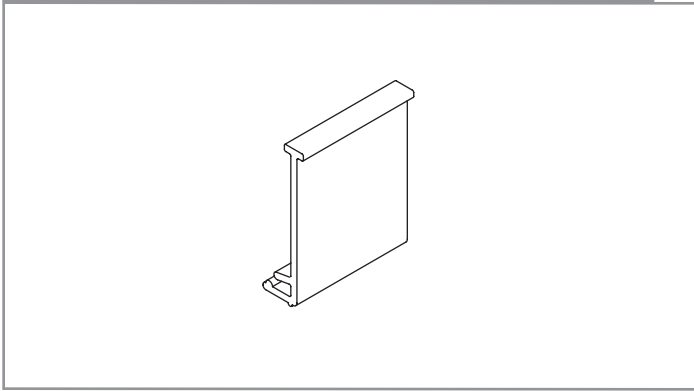

Part Number: 750763

2 Screen Spline

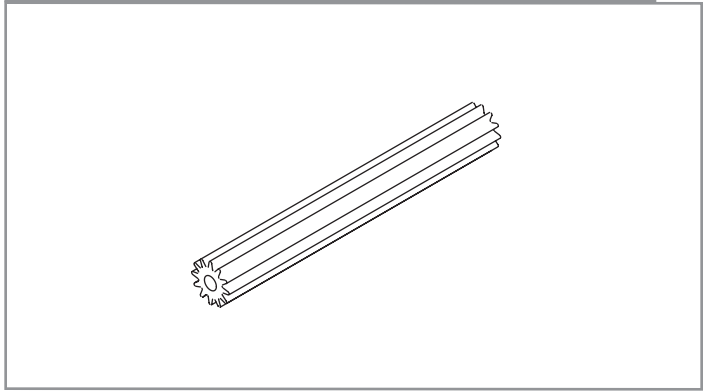

Configured Number: C761554
Part Number: 741584 (AS400 use only)
Extrusion Number: 1018

SCENA-VU

3 Screen Spring

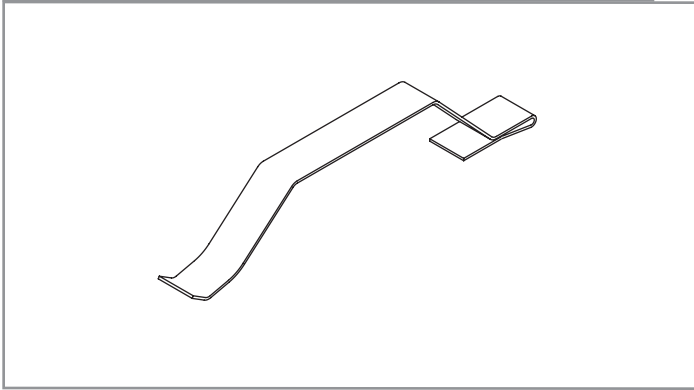

Part Number: 972570