

Structural Performance Data

Signature 1-3/4" Outswing French Door (8610)

WEATHER SHIELD.

WINDOWS & DOORS

Unit Style	Model Number	Size Tested (total frame size)	AAMA/WDMA/CSA 101/I.S.2/A440-08	Design Pressure Rating (psf)	Structural Test Pressure (psf)	Water Performance (psf)	Air Infiltration (cfm/ft ²)	Forced Entry Resistance	Data Valid Until
French Outswing Door - 2 Panel Standard Sill ¹	8610	73-11/16" x 99-3/32"	LC-PG50-SHD	+50/-50	+75/-75	7.50	0.04	Grade 10	3/1/2022
French Outswing Door - 2 Panel Low profile Sill ¹	8610	73-11/16" x 98-7/16"	LC-PG45-SHD	+45/-45	+67.5/-67.5	6.75	0.01	Grade 10	3/1/2022
French Outswing Door - 2 Panel Standard Sill ²	8610	73-11/16" x 86-1/32"	LC-PG50-SHD	+50/-50	+75/-75	7.50	0.14	Grade 10	2/5/2023
French Outswing Door - 2 Panel Standard Sill ³	8610	73-11/16" x 86-1/32"	LW LC-PG30-SHD	+30/-30	+45/-45	2.86	0.05	Grade 10	2/5/2023
French Outswing Door - 1 Panel Standard Sill ⁴	8610	37-17/32" x 99-3/32"	LC-PG40-SHD	+40/-40	+60/-60	6.00	0.04	Grade 10	5/28/2023
French Outswing Door Sidelite - Standard Sill	8610	37-17/32" x 99-3/32"	CW-PG60-SLT	+60/-60	+90/-90	9.00	0.02	Grade 10	4/22/2023

Revised 4/1/19

¹Units tested with Ashland 3-point lock, 2-point handle activated flush bolts, adjustable hinges.

²Units tested with Ashland 3-point lock, manual flush bolts, butt hinges.

³Units tested with Rockwell single-point lock, Ashland manual flush bolts, butt hinges.

⁴Units tested with Ashland single-point lock, adjustable hinges.

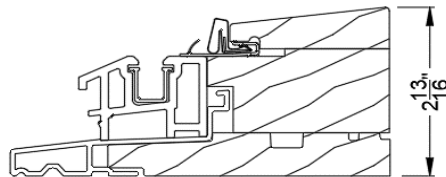

Standard Sill

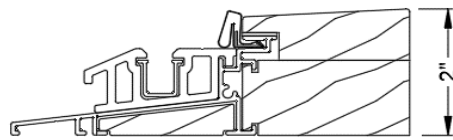

Low Profile Sill